

Mercedes Benz E-class 09y~ (W212)

WALD SPORTS LINE
BLACK BISON EDITION

INSTALLATION MANUAL
WALD
Sportliche Autoausrüstung WALD International

THANK YOU FOR PURCHASING. THIS IS THE INSTALLATION MANUAL OF WALD FRONT BUMPER FOR MERCEDES-BENZ W212 E-CLASS.
PLEASE READ THIS MANUAL CAREFULLY BEFORE THE INSTALLATION.

ATTENTION



- ※ NO RETURNS CAN BE ACCEPTED BECAUSE OF IMPROPER INSTALLATION OR PAINTING.
- ※ CHECK THE FITMENT, AND ADJUST ALL THE DETAILS BEFORE PAINTING.
- We assume no responsibility for any damage resulting from improper installation, painting, modification and any cut wound in unsealing.
- Contact the car dealer when you have any question in removing OEM parts.
- During all the installation process, use parking brake and stop the engine completely.
- Use rasps or sandpapers to fit the products to the body if there is an individual difference.
- The product is made of FRP. Handle with care. Do not give the excessive force. Gradually fix the bolts and nuts by checking the fitment and balance of the installation.
- Check the fitment, and adjust all the details of the fitment steady and proper. Please check the fitment and all the details regularly, fix the bolts and nuts as necessary.
- The instruction of painting is just our recommendation, please paint it as you like.
- ※ PLEASE BE AWARE OF:
 - You may lose the warranty and all the services from the car maker, because of replacing OEM parts.
 - Reduced road clearance may cause inconvenience in using parking curbs and garage jack.
 - FRP, ABS and PPE products are slightly weaker than OEM parts in crashes.
 - The product may not match the body and OEM color perfectly.

Please purchase double sided tape, primer and caulking glue at auto accessory shop or hardware store.

Completely degrease and paint primer on all the installation positions to enhance the viscosity of double sided tape.

Use dryer to warm double sided tape to enhance the viscosity in low temperature.

Keep the car in a dry condition more than 24 hours after gluing.

Do not wash the car during this time.

	PARTS	QUANTITIES
FRONT BUMPER	FRONT BUMPER	1
	MESHES	1 SET

Use caulking glue to fill the gap between the product and the body.

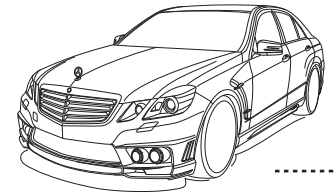

FRONT BUMPER

【BEFORE PAINTING】

- 1) Remove OEM front bumper according to the Mercedes-Benz service manual.
- 2) Relocate OEM bumper support to WALD Front Bumper.
- ※ Cut OEM bumper support according to the picture.
- 3) Temporarily install WALD Front Bumper to the body.
- ※ Adjust the details of WALD Front Bumper to fit the body by rasps or sandpapers.
- 4) Paint WALD Front Bumper according to the picture.

【AFTER PAINTING】

- 5) Install the fog lamp kit to WALD Front Bumper.
- ※ Make sure the fog lamp kit is fine to work before the installation.
- 6) Use caulking glue to install the attached meshes to WALD Front Bumper from the rear.
- 7) Relocate OEM license plate bracket and grille to WALD Front Bumper.
- 8) Temporarily fix OEM bolts, clips and tapping screws to install WALD Front Bumper to the body.
- 9) Check all the details of the fitment, then fix them.

■ HOW TO CUT OEM BUMPER SUPPORT (STEP 2)

Cut OEM bumper support according to the picture.

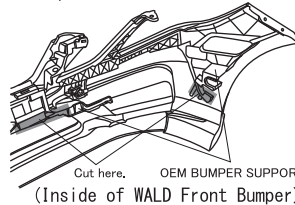

■ LOCATION OF THE ATTACHED MESHES (STEP 6)

Use pins and caulking glue to install the attached meshes to WALD Front Bumper from the rear.

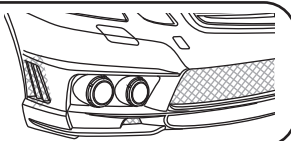

※ WALD SHOWCAR IS PAINTED LIKE THE PICTURE

MATTE BLACK

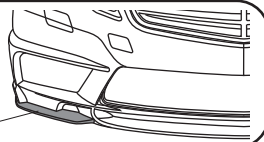

OEM BOLT

OEM CLIP

OEM TAPPING SCREW



ATTENTION

※ MORE THAN 2 TECHNICIANS ARE NECESSARY IN THIS WORK.
DURING ALL THE INSTALLATION PROCESS, PLEASE BE CAREFUL NOT TO DAMAGE THE BODY.

Mercedes Benz E-class 09y~ (W212)

WALD SPORTS LINE
BLACK BISON EDITION

INSTALLATION MANUAL
WALD
Sportliche Autoausrüstung WALD International

THANK YOU FOR PURCHASING. THIS IS THE INSTALLATION MANUAL OF WALD SIDE STEPS FOR MERCEDES-BENZ W212 E-CLASS.
PLEASE READ THIS MANUAL CAREFULLY BEFORE THE INSTALLATION.

ATTENTION



- ※ NO RETURNS CAN BE ACCEPTED BECAUSE OF IMPROPER INSTALLATION OR PAINTING.
- ※ CHECK THE FITMENT, AND ADJUST ALL THE DETAILS BEFORE PAINTING.
- We assume no responsibility for any damage resulting from improper installation, painting, modification and any cut wound in unsealing.
- Contact the car dealer when you have any question in removing OEM parts.
- During all the installation process, use parking brake and stop the engine completely.
- Use rasps or sandpapers to fit the products to the body if there is an individual difference.
- The product is made of FRP. Handle with care. Do not give the excessive force. Gradually fix the bolts and nuts by checking the fitment and balance of the installation.
- Check the fitment, and adjust all the details of the fitment steady and proper. Please check the fitment and all the details regularly, fix the bolts and nuts as necessary.
- The instruction of painting is just our recommendation, please paint it as you like.
- ※ PLEASE BE AWARE OF:
 - You may lose the warranty and all the services from the car maker, because of replacing OEM parts.
 - Reduced road clearance may cause inconvenience in using parking curbs and garage jack.
 - FRP, ABS and PPE products are slightly weaker than OEM parts in crashes.
 - The product may not match the body and OEM color perfectly.

Please purchase double sided tape, primer and caulking glue at auto accessory shop or hardware store.

Completely degrease and paint primer on all the installation positions to enhance the viscosity of double sided tape.

Use dryer to warm double sided tape to enhance the viscosity in low temperature.

Keep the car in a dry condition more than 24 hours after gluing.

Do not wash the car during this time.

	PARTS	QUANTITIES
SIDE STEP	SIDE STEPS	1 SET
	BRACKETS	2
	BOLTS (M6 x 12) & NUTS	2 SETS

Use caulking glue to fill the gap between the product and the body.

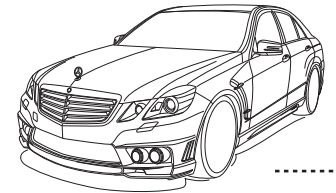

SIDE STEP

[BEFORE PAINTING]

- 1) Remove OEM side steps according to the Mercedes-Benz service manual.
- 2) Temporarily install WALD Side Steps to the body.
- ※ Adjust the details of WALD Side Steps to fit the body by rasps or sandpapers.
- 3) Paint WALD Side Steps according to the picture.

[AFTER PAINTING]

- 4) Completely degrease the installation positions of WALD Side Steps.
- 5) Temporarily fix the attached brackets, bolts, nuts, OEM clips and use caulking glue to install WALD Side Steps to the body.
- 6) Check all the details of the fitment, then fix them.
- 7) Use masking tape to fix WALD Side Steps, leave them till completely fixed.

※ WALD SHOWCAR IS PAINTED LIKE THE PICTURE (STEP 3)

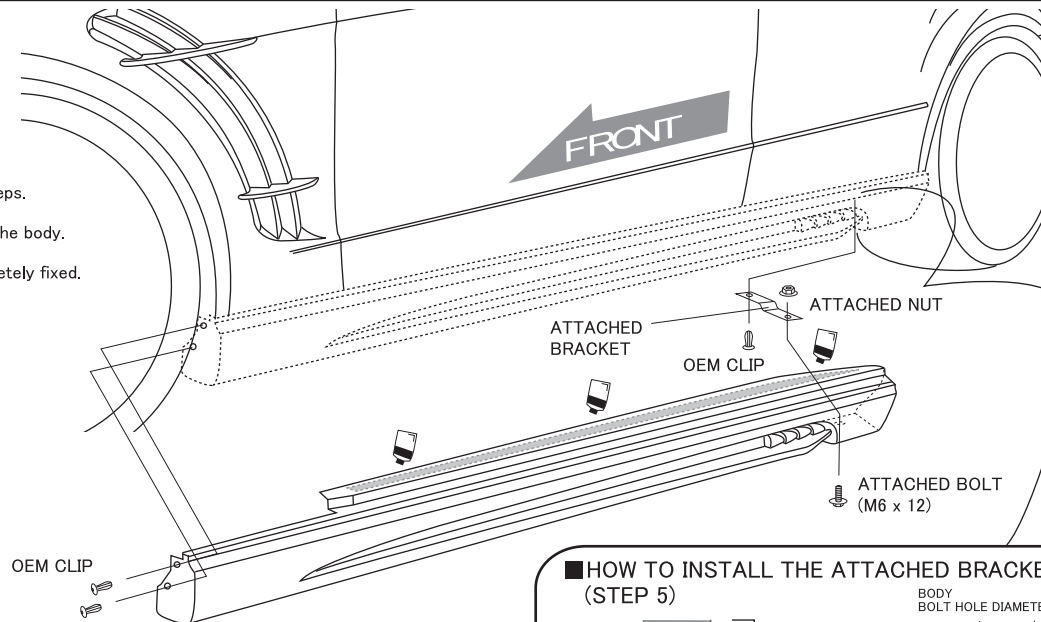
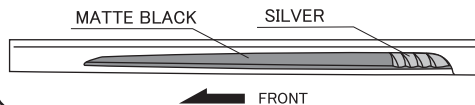

■ HOW TO INSTALL THE ATTACHED BRACKET (STEP 5)

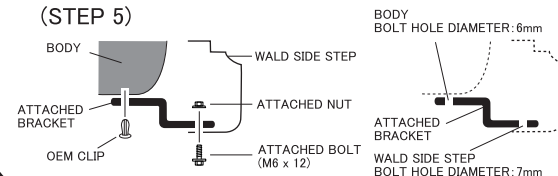

ATTENTION



- ※ MORE THAN 2 TECHNICIANS ARE NECESSARY IN THIS WORK. DURING ALL THE INSTALLATION PROCESS, PLEASE BE CAREFUL NOT TO DAMAGE THE BODY.
- ※ DEGREASE ALL THE INSTALLATION POSITIONS, AND REMOVE THE BODY PROTECTION COATING BEFORE THE INSTALLATION.

WALD INTERNATIONAL

Mercedes Benz E-class 09y~ (W212)

WALD SPORTS LINE
BLACK BISON EDITION

INSTALLATION MANUAL
WALD
Sportliche Autoausrüstung WALD International

THANK YOU FOR PURCHASING. THIS IS THE INSTALLATION MANUAL OF WALD REAR BUMPER FOR MERCEDES-BENZ W212 E-CLASS.
PLEASE READ THIS MANUAL CAREFULLY BEFORE THE INSTALLATION.

ATTENTION



- ※ NO RETURNS CAN BE ACCEPTED BECAUSE OF IMPROPER INSTALLATION OR PAINTING.
- ※ CHECK THE FITMENT, AND ADJUST ALL THE DETAILS BEFORE PAINTING.
- We assume no responsibility for any damage resulting from improper installation, painting, modification and any cut wound in unsealing.
- Contact the car dealer when you have any question in removing OEM parts.
- During all the installation process, use parking brake and stop the engine completely.
- Use rasps or sandpapers to fit the products to the body if there is an individual difference.
- The product is made of FRP. Handle with care. Do not give the excessive force. Gradually fix the bolts and nuts by checking the fitment and balance of the installation.
- Check the fitment, and adjust all the details of the fitment steady and proper. Please check the fitment and all the details regularly, fix the bolts and nuts as necessary.
- The instruction of painting is just our recommendation, please paint it as you like.
- ※ PLEASE BE AWARE OF:
 - You may lose the warranty and all the services from the car maker, because of replacing OEM parts.
 - Reduced road clearance may cause inconvenience in using parking curbs and garage jack.
 - FRP, ABS and PPE products are slightly weaker than OEM parts in crashes.
 - The product may not match the body and OEM color perfectly.

Please purchase double sided tape, primer and caulking glue at auto accessory shop or hardware store.

Completely degrease and paint primer on all the installation positions to enhance the viscosity of double sided tape.

Use dryer to warm double sided tape to enhance the viscosity in low temperature.

Keep the car in a dry condition more than 24 hours after gluing.

Do not wash the car during this time.

	PARTS	QUANTITIES
REAR BUMPER	REAR BUMPER	1
	REFLECTORS	2
	BRACKETS (Z-TYPE, U-SHAPED)	4
	BOLTS (M6 x 12) & NUTS	6 SETS
	MESHES	1 SET

Use caulking glue to fill the gap between the product and the body.

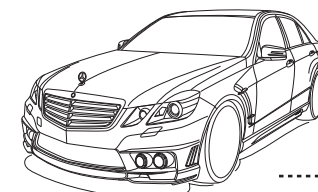

REAR BUMPER

【BEFORE PAINTING】

- 1) Remove OEM rear bumper according to the Mercedes-Benz service manual.
- 2) Temporarily install WALD Rear Bumper to the body.
- ※ Adjust the details of WALD Rear Bumper to fit the body by rasps or sandpapers.
- 3) Paint WALD Rear Bumper according to the picture.

【AFTER PAINTING】

- 4) Install the attached brackets to the body.
- 5) Use caulking glue to install the attached meshes to WALD Rear Bumper from the rear.
- 6) Install the attached reflectors to WALD Rear Bumper.
- 7) Temporarily fix the attached bolts, nuts, brackets, OEM U-type nuts, tapping screws and clips to install WALD Rear Bumper to the body.
- 8) Check all the details of the fitment, then fix them.

■ LOCATION OF THE ATTACHED MESHES (STEP 5)

Use pins and caulking glue to install the attached meshes to WALD Rear Bumper from the rear.

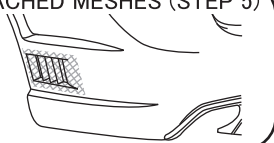

※ WALD SHOWCAR IS PAINTED LIKE THE PICTURE (STEP 3)

MATTE BLACK

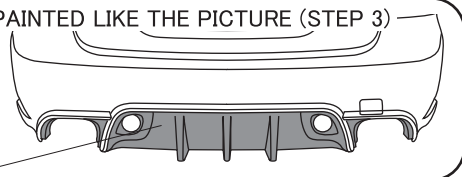

※ MORE THAN 2 TECHNICIANS ARE NECESSARY IN THIS WORK.
DURING ALL THE INSTALLATION PROCESS,
PLEASE BE CAREFUL NOT TO DAMAGE THE BODY.

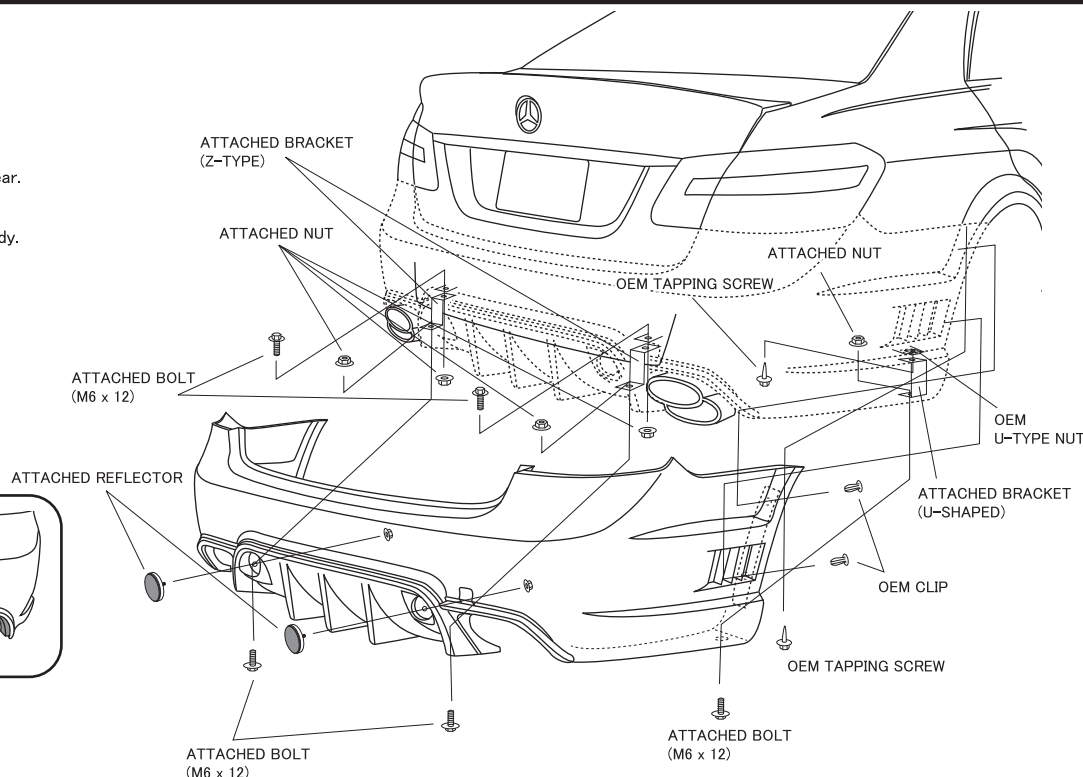

WALD INTERNATIONAL

Mercedes Benz E-class 09y~ (W212)

WALD SPORTS LINE
BLACK BISON EDITION

INSTALLATION MANUAL
WALD
Sportliche Autoausrüstung WALD International

THANK YOU FOR PURCHASING. THIS IS THE INSTALLATION MANUAL OF WALD SPORTS FENDER DUCTS FOR MERCEDES-BENZ W212 E-CLASS.
PLEASE READ THIS MANUAL CAREFULLY BEFORE THE INSTALLATION.

ATTENTION



- ※ NO RETURNS CAN BE ACCEPTED BECAUSE OF IMPROPER INSTALLATION OR PAINTING.
- ※ CHECK THE FITMENT, AND ADJUST ALL THE DETAILS BEFORE PAINTING.
- We assume no responsibility for any damage resulting from improper installation, painting, modification and any cut wound in unsealing.
- Contact the car dealer when you have any question in removing OEM parts.
- During all the installation process, use parking brake and stop the engine completely.
- Use rasps or sandpapers to fit the products to the body if there is an individual difference.
- The product is made of FRP. Handle with care. Do not give the excessive force. Gradually fix the bolts and nuts by checking the fitment and balance of the installation.
- Check the fitment, and adjust all the details of the fitment steady and proper. Please check the fitment and all the details regularly, fix the bolts and nuts as necessary.
- The instruction of painting is just our recommendation, please paint it as you like.
- ※ PLEASE BE AWARE OF:
 - You may lose the warranty and all the services from the car maker, because of replacing OEM parts.
 - Reduced road clearance may cause inconvenience in using parking curbs and garage jack.
 - FRP, ABS and PPE products are slightly weaker than OEM parts in crashes.
 - The product may not match the body and OEM color perfectly.

Please purchase double sided tape, primer and caulking glue at auto accessory shop or hardware store.

Completely degrease and paint primer on all the installation positions to enhance the viscosity of double sided tape.

Use dryer to warm double sided tape to enhance the viscosity in low temperature.

Keep the car in a dry condition more than 24 hours after gluing.

Do not wash the car during this time.

	PARTS	QUANTITIES
SPORTS FENDER DUCT	SPORTS FENDER DUCTS	1 SET
	FINS	2 SETS
	MESHERS	1 SET

Use caulking glue to fill the gap between the product and the body.

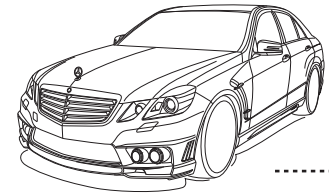

SPORTS FENDER DUCT

[BEFORE PAINTING]

- 1) Remove OEM front fenders according to the Mercedes-Benz service manual.
- 2) Temporarily install WALD Sports Fender Ducts to the body.
- ※ Adjust the details of WALD Sports Fender Ducts to fit the body by rasps or sandpapers.
- 3) Temporarily install the attached fins to WALD Sports Fender Ducts, then mark the installation positions on WALD Sports Fender Ducts to make holes.
- 4) Remove WALD Sports Fender Ducts, then make holes on them according to the marked positions.

[AFTER PAINTING]

- 5) Use caulking glue to install the attached meshes to WALD Sports Fender Ducts from the rear.
- 6) Install the attached fins to WALD Sports Fender Ducts.
- 7) Temporarily fix OEM U-type nuts, tapping screws, bolts, nuts and the attached nuts to install WALD Sports Fender Ducts to the body.
- 8) Check all the details of the fitment, then fix them.

■ LOCATION OF THE ATTACHED MESHERS (STEP 5)

Use pins and caulking glue to install the attached meshes to WALD Sports Fender Ducts from the rear.

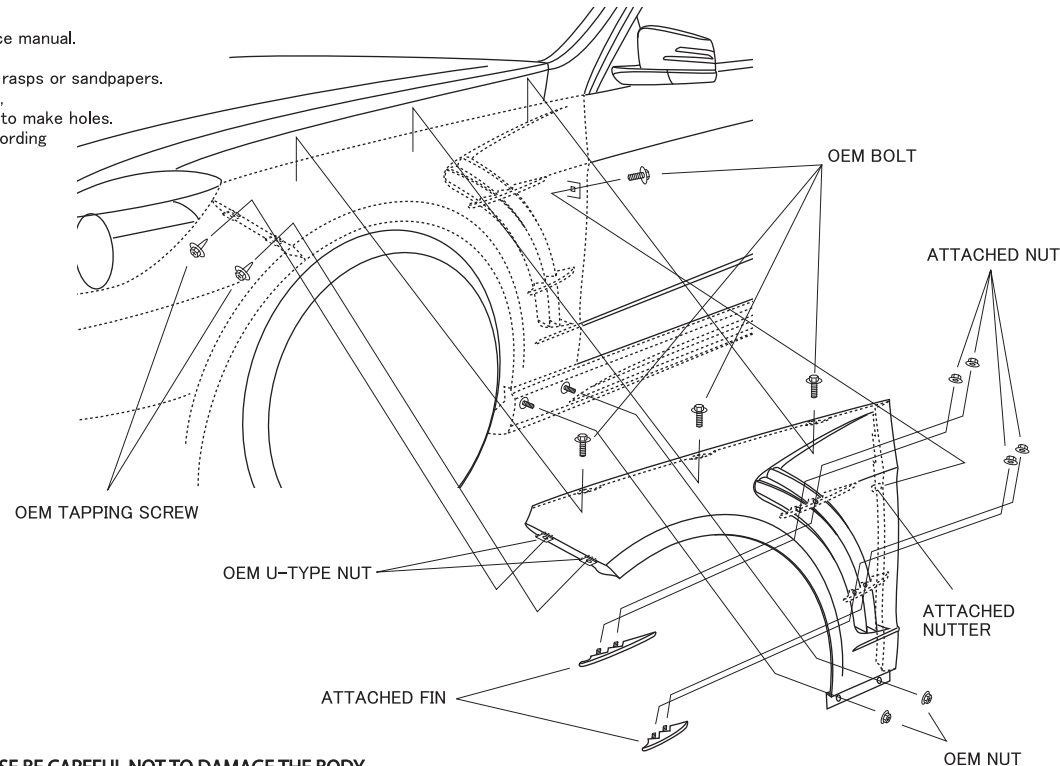
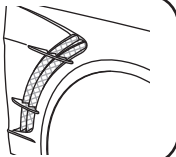

ATTENTION

- ※ PROCESS EACH SIDE AT A TIME.
- ※ DURING ALL THE INSTALLATION PROCESS, PLEASE BE CAREFUL NOT TO DAMAGE THE BODY.



WALD INTERNATIONAL

WALD INTERNATIONAL

ADD: 10-13 KYOGUCHI-CHO, TAKATSUKI, OSAKA, JAPAN ZIP: 569-0072 TEL: (81)-72-673-3000 FAX: (81)-72-673-3003

Mercedes Benz E-class 09y~ (W212)

WALD SPORTS LINE
BLACK BISON EDITION

INSTALLATION MANUAL
WALD
Sportliche Autoausrüstung WALD International

THANK YOU FOR PURCHASING. THIS IS THE INSTALLATION MANUAL OF WALD TRUNK SPOILER AND ROOF SPOILER FOR MERCEDES-BENZ W212 E-CLASS.
PLEASE READ THIS MANUAL CAREFULLY BEFORE THE INSTALLATION.

ATTENTION



- ※ NO RETURNS CAN BE ACCEPTED BECAUSE OF IMPROPER INSTALLATION OR PAINTING.
- ※ CHECK THE FITMENT, AND ADJUST ALL THE DETAILS BEFORE PAINTING.
- We assume no responsibility for any damage resulting from improper installation, painting, modification and any cut wound in unsealing.
- Contact the car dealer when you have any question in removing OEM parts.
- During all the installation process, use parking brake and stop the engine completely.
- Use rasps or sandpapers to fit the products to the body if there is an individual difference.
- The product is made of FRP. Handle with care. Do not give the excessive force. Gradually fix the bolts and nuts by checking the fitment and balance of the installation.
- Check the fitment, and adjust all the details of the fitment steady and proper. Please check the fitment and all the details regularly, fix the bolts and nuts as necessary.
- The instruction of painting is just our recommendation, please paint it as you like.
- ※ PLEASE BE AWARE OF:
 - You may lose the warranty and all the services from the car maker, because of replacing OEM parts.
 - Reduced road clearance may cause inconvenience in using parking curbs and garage jack.
 - FRP, ABS and PPE products are slightly weaker than OEM parts in crashes.
 - The product may not match the body and OEM color perfectly.

Please purchase double sided tape, primer and caulking glue at auto accessory shop or hardware store.

Completely degrease and paint primer on all the installation positions to enhance the viscosity of double sided tape.

Use dryer to warm double sided tape to enhance the viscosity in low temperature.

Keep the car in a dry condition more than

24 hours after gluing.

Do not wash the car during this time.

	PARTS	QUANTITIES
TRUNK SPOILER	TRUNK SPOILER	1
ROOF SPOILER	ROOF SPOILER	1



Use caulking glue to fill the gap between the product and the body.

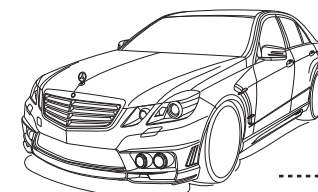

TRUNK SPOILER & ROOF SPOILER

【BEFORE PAINTING】

- 1) Temporarily install WALD Trunk Spoiler and Roof Spoiler to the body.
- 2) Check the fitment, then use masking tape to mark the installation positions.

【AFTER PAINTING】

- 3) Degrease the installation position on WALD Trunk Spoiler to fix OEM emblem, then use double sided tape to relocate OEM emblem to WALD Trunk Spoiler.
- 4) Completely degrease the installation positions of WALD Trunk Spoiler and Roof Spoiler, then use caulking glue to install them to the body according to the marked positions.
- 5) Check all the details of the fitment, then use masking tape to fix them.
- 6) Leave them till completely fixed.

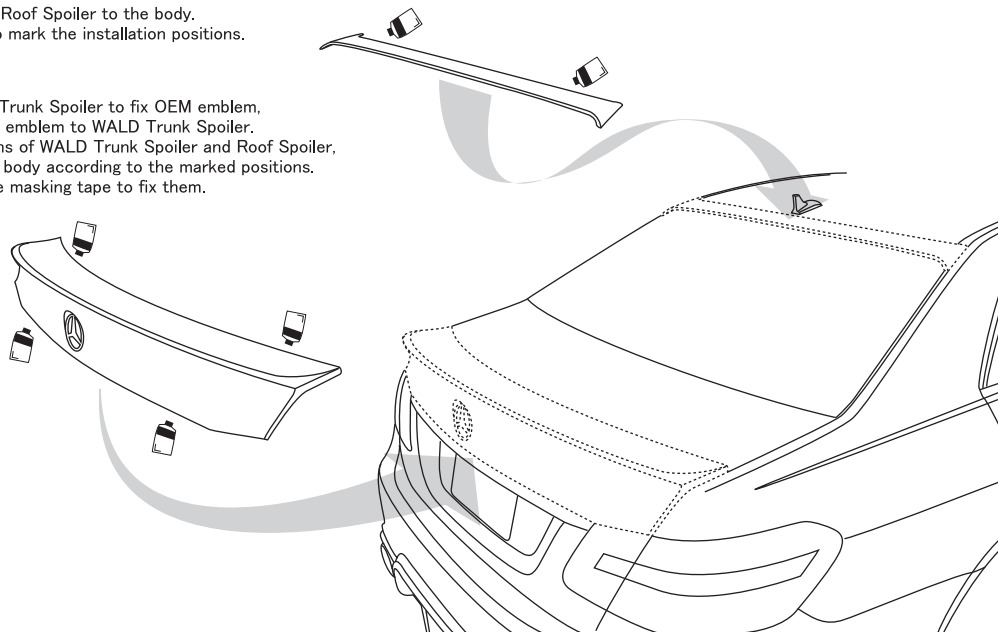

ATTENTION

- ※ MORE THAN 2 TECHNICIANS ARE NECESSARY IN THIS WORK.
- DURING ALL THE INSTALLATION PROCESS, PLEASE BE CAREFUL NOT TO DAMAGE THE BODY.
- ※ DEGREASE ALL THE INSTALLATION POSITIONS, AND REMOVE THE BODY PROTECTION COATING BEFORE THE INSTALLATION.



WALD INTERNATIONAL

WALD INTERNATIONAL

ADD: 10-13 KYOGUCHI-CHO, TAKATSUKI, OSAKA, JAPAN ZIP: 569-0072 TEL: (81)-72-673-3000 FAX: (81)-72-673-3003

Mercedes Benz E-class 09y~ (W212)

WALD SPORTS LINE
BLACK BISON EDITION

INSTALLATION MANUAL
WALD
Sportliche Autoausrüstung WALD International

THANK YOU FOR PURCHASING. THIS IS THE INSTALLATION MANUAL OF FOG LAMP KIT OF WALD FRONT BUMPER FOR MERCEDES-BENZ W212 E-CLASS.
PLEASE READ THIS MANUAL CAREFULLY BEFORE THE INSTALLATION.

ATTENTION



- ※ NO RETURNS CAN BE ACCEPTED BECAUSE OF IMPROPER INSTALLATION OR PAINTING.
- ※ CHECK THE FITMENT, AND ADJUST ALL THE DETAILS BEFORE PAINTING.
- We assume no responsibility for any damage resulting from improper installation, painting, modification and any cut wound in unsealing.
- Contact the car dealer when you have any question in removing OEM parts.
- During all the installation process, use parking brake and stop the engine completely.
- Use rasps or sandpapers to fit the products to the body if there is an individual difference.
- The product is made of FRP. Handle with care. Do not give the excessive force. Gradually fix the bolts and nuts by checking the fitment and balance of the installation.
- Check the fitment, and adjust all the details of the fitment steady and proper. Please check the fitment and all the details regularly, fix the bolts and nuts as necessary.
- The instruction of painting is just our recommendation, please paint it as you like.
- ※ PLEASE BE AWARE OF:
 - You may lose the warranty and all the services from the car maker, because of replacing OEM parts.
 - Reduced road clearance may cause inconvenience in using parking curbs and garage jack.
 - FRP, ABS and PPE products are slightly weaker than OEM parts in crashes.
 - The product may not match the body and OEM color perfectly.

Please purchase double sided tape, primer and caulking glue at auto accessory shop or hardware store.

Completely degrease and paint primer on all the installation positions to enhance the viscosity of double sided tape.

Use dryer to warm double sided tape to enhance the viscosity in low temperature.

Keep the car in a dry condition more than 24 hours after gluing.

Do not wash the car during this time.

	PARTS	QUANTITIES
FOG LAMP KIT	FOG LAMPS	2 SETS
	FOG LAMP COVERS	1 SET
	BRACKETS	4
	BOLTS (M5 x 15) & NUTS	22 SETS

Use caulking glue to fill the gap between the product and the body.

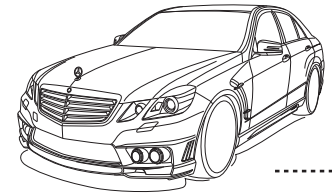

FOG LAMP KIT

【BEFORE PAINTING】

- 1) Temporarily fix the attached bolts and nuts (A) to install the fog lamp covers to WALD Front Bumper.
- ※ Adjust the details of WALD Front Bumper and the fog lamp covers to fit by rasps or sandpapers.
- 2) Temporarily fix the attached bolts and nuts (B) to install the fog lamps to the attached brackets.
- ※ Match each direction before the installation.
- ※ Adjust the details of WALD Front Bumper and the attached brackets to fit by rasps or sandpapers.
- 3) Prepare to connect the fog lamps.
- 4) Paint the fog lamp covers according to the picture.

【AFTER PAINTING】

- 5) Temporarily fix the attached bolts and nuts to install the fog lamps and fog lamp covers to WALD Front Bumper.
- 6) Check all the details of the fitment and optical axis, then fix them.
- 7) Use relay harness with remote controller kit to turn on the LED rings and fog lamps separately.

- ※ WALD SHOWCAR IS PAINTED LIKE THE PICTURE (STEP 4)

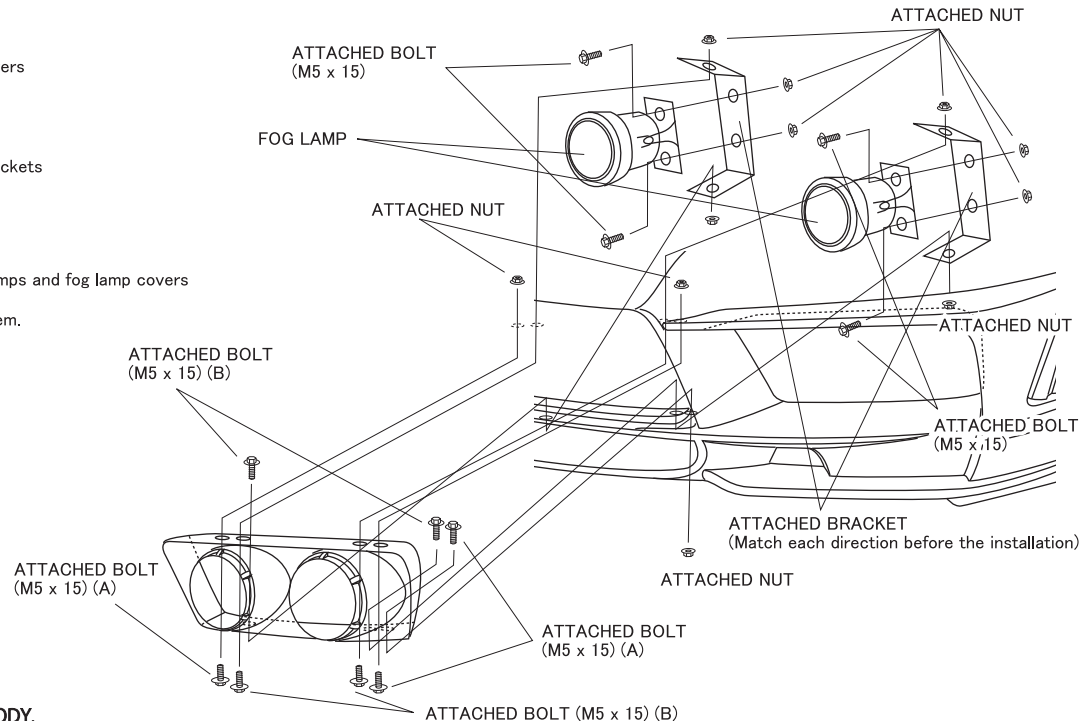
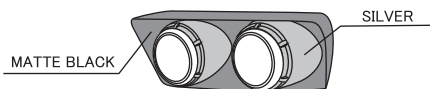

ATTENTION

- ※ DURING ALL THE INSTALLATION PROCESS, PLEASE BE CAREFUL NOT TO DAMAGE THE BODY.
- ※ REMOVE THE BATTERY BEFORE ALL THE WIRING WORKS.
- ※ MAKE SURE THE FOG LAMPS ARE FINE TO WORK BEFORE THE INSTALLATION.

Mercedes Benz E-class 09y~ (W212)

WALD SPORTS LINE
BLACK BISON EDITION

INSTALLATION MANUAL
WALD
Sportliche Autoausrüstung WALD International

THANK YOU FOR PURCHASING. THIS IS THE INSTALLATION MANUAL OF LED NIGHT SYSTEM INSERT ADAPTERS OF WALD FRONT BUMPER FOR MERCEDES-BENZ W212 E-CLASS.
PLEASE READ THIS MANUAL CAREFULLY BEFORE THE INSTALLATION.

ATTENTION



- ※ NO RETURNS CAN BE ACCEPTED BECAUSE OF IMPROPER INSTALLATION OR PAINTING.
- ※ CHECK THE FITMENT, AND ADJUST ALL THE DETAILS BEFORE PAINTING.
- We assume no responsibility for any damage resulting from improper installation, painting, modification and any cut wound in unsealing.
- Contact the car dealer when you have any question in removing OEM parts.
- During all the installation process, use parking brake and stop the engine completely.
- Use rasps or sandpapers to fit the products to the body if there is an individual difference.
- The product is made of FRP. Handle with care. Do not give the excessive force. Gradually fix the bolts and nuts by checking the fitment and balance of the installation.
- Check the fitment, and adjust all the details of the fitment steady and proper. Please check the fitment and all the details regularly, fix the bolts and nuts as necessary.
- The instruction of painting is just our recommendation, please paint it as you like.
- ※ PLEASE BE AWARE OF:
 - You may lose the warranty and all the services from the car maker, because of replacing OEM parts.
 - Reduced road clearance may cause inconvenience in using parking curbs and garage jack.
 - FRP, ABS and PPE products are slightly weaker than OEM parts in crashes.
 - The product may not match the body and OEM color perfectly.

Please purchase double sided tape, primer and caulking glue at auto accessory shop or hardware store.

Completely degrease and paint primer on all the installation positions to enhance the viscosity of double sided tape.

Use dryer to warm double sided tape to enhance the viscosity in low temperature.

Keep the car in a dry condition more than 24 hours after gluing.

Do not wash the car during this time.

	PARTS	QUANTITIES
LED NIGHT SYSTEM INSERT ADAPTER	LED LAMPS (LIGHT REDUCTION)	1 SET
	INSERT ADAPTERS	1 SET
	MESHERS	1 SET
	BOLTS (M6 x 12)	4
	TAPPING SCREWS (M4 x 10)	4
	U-TYPE NUTS	4
	RESISTORS (25W, 10Ω)	2

Use caulking glue to fill the gap between the product and the body.

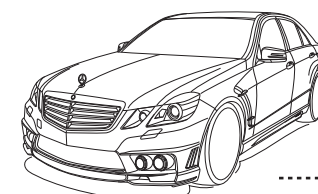

LED NIGHT SYSTEM INSERT ADAPTER

【BEFORE PAINTING】

- 1) Remove WALD Front Bumper according to the installation manual.
- 2) Temporarily install the insert adapters to WALD Front Bumper.
 - ※ Adjust the details of the insert adapters to fit WALD Front Bumper by rasps or sandpapers.
- 3) Use the attached bolts and nuts to install the insert adapters to WALD Front Bumper from the rear.
Mark the installation positions on WALD Front Bumper and the insert adapters to insert the attached tapping screws according to the fixed attached bolts, then make holes.
- 4) Remove the insert adapters, then install the attached U-type nuts to them according to the picture.
- 5) Install the insert adapters to WALD Front Bumper, then temporarily install LED lamps to the insert adapters.
 - ※ Adjust the details of the insert adapters to fit LED lamps by rasps or sandpapers.
- 6) Prepare to connect the LED lamps with the attached resistors.
- 7) Paint the insert adapters according to the picture.

【AFTER PAINTING】

- 8) Use pins and caulking glue to install the attached meshes to the insert adapters from the rear.
- 9) Install the insert adapters to WALD Front Bumper, then install the LED lamps to the insert adapters.
- 10) Check all the details of the fitment, then fix all the tapping screws, bolts and nuts.
- 11) Connect the LED lamps.

■ HOW TO INSTALL THE ATTACHED U-TYPE NUTS AND MESHERS

Install the attached U-type nuts according to the picture. (STEP 4)

Use pins and caulking glue to install the attached meshes (STEP 8) to the insert adapters from the rear.

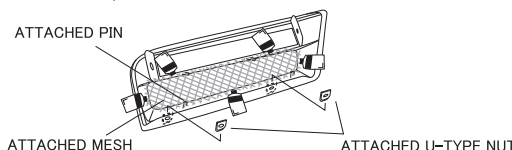

■ HOW TO INSTALL THE ATTACHED RESISTORS (STEP 6)

Connect the attached resistors to the harness of OEM fog lamps when the warning lamp is on.



※ Install the attached resistors away from the harness to prevent the heat of the attached resistors.

※ WALD SHOWCAR IS (STEP 7) PAINTED LIKE THE PICTURE

Paint it into matte black.

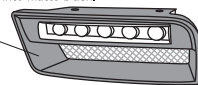

LED LAMP

ATTACHED NUT (M5) (From WALD Front Bumper)

ATTACHED BOLT (M6 x 12)

ATTACHED U-TYPE NUT

ATTACHED BOLT (M6 x 12)

ATTACHED TAPPING SCREW (M4 x 10)

INSERT ADAPTER

ATTACHED MESH

ATTACHED BOLT (M5 x 15)
(From WALD Front Bumper)



ATTENTION

- ※ DURING ALL THE INSTALLATION PROCESS, PLEASE BE CAREFUL NOT TO DAMAGE THE BODY.
- ※ REMOVE THE BATTERY BEFORE ALL THE WIRING WORKS.
- ※ MAKE SURE THE LED LAMPS ARE FINE TO WORK BEFORE THE INSTALLATION.