

LEXUS LX570

WALD SPORTS LINE
BLACK BISON EDITION

INSTALLATION MANUAL
WALD
Sportliche Autoausrüstung WALD.International

THANK YOU FOR PURCHASING. THIS IS THE INSTALLATION MANUAL OF WALD FRONT BUMPER FOR LEXUS LX570.

ATTENTION



- ※ NO RETURNS CAN BE ACCEPTED BECAUSE OF IMPROPER INSTALLATION OR PAINTING.
- ※ CHECK THE FITMENT, AND ADJUST ALL THE DETAILS BEFORE PAINTING.
- We assume no responsibility for any damage resulting from improper installation, painting, modification and any cut wound in unsealing.
- Contact the car dealer when you have any question in removing OEM parts.
- During all the installation process, use parking brake and stop the engine completely.
- Use rasps or sandpapers to fit the products to the body if there is an individual difference.
- The product is made of FRP. Handle with care. Do not give the excessive force.
- Gradually fix the bolts and nuts by checking the fitment and balance of the installation.
- After making a hole on the body, make the corrosion treatment on it.
- Check the fitment, and adjust all the details of the fitment steady and proper.
- Please check the fitment and all the details regularly, fix the bolts and nuts as necessary.
- The instruction of painting is just our recommendation, please paint it as you like.
- ※ PLEASE BE AWARE OF:
 - You may lose the warranty and all the services from the car maker, because of replacing OEM parts.
 - Reduced road clearance may cause inconvenience in using parking curbs and garage jack.
 - FRP, ABS and PPE products are slightly weaker than OEM parts in crashes.
 - The product may not match the body and OEM color perfectly.

Please purchase double sided tape, primer and caulking glue at auto accessory shop or hardware store.

Completely degrease and paint primer on all the installation positions to enhance the viscosity of double sided tape.
Use dryer to warm double sided tape to enhance the viscosity in low temperature.
Keep the car in a dry condition more than 24 hours after gluing.
Do not wash the car during this time.

	PARTS	QUANTITIES
FRONT BUMPER	FRONT BUMPER	1
	MESHERS	1 SET
	LED LAMP KIT (FOG or LED)	1 SET



Use caulking glue to fill the gap between the product and the body.

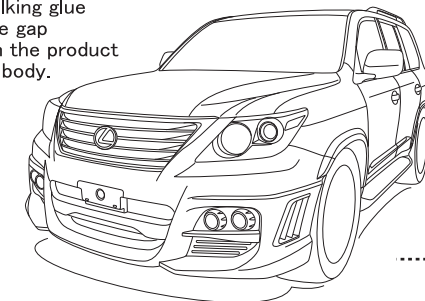

FRONT BUMPER

【BEFORE PAINTING】

- 1) Remove OEM front bumper according to the Lexus service manual.
 - 2) Relocate OEM headlight washer covers and nozzles to WALD Front Bumper.
 - 3) Temporarily install WALD Front Bumper to the body.
- ※ Adjust the details of WALD Front Bumper to fit the body by rasps or sandpapers.
- 4) Paint WALD Front Bumper according to the picture.

【AFTER PAINTING】

- 5) Install the attached LED lamp kit to WALD Front Bumper.
- ※ Make sure the attached LED lamp kit is fine to work before the installation.
- 6) Use caulking glue to install the attached meshes to WALD Front Bumper from the rear.
 - 7) Temporarily fix OEM tapping screws and clips to install WALD Front Bumper to the body.
 - 8) Check all the details of the fitment, then fix them.

※WALD SHOWCAR IS PAINTED LIKE THE PICTURE (STEP 4)

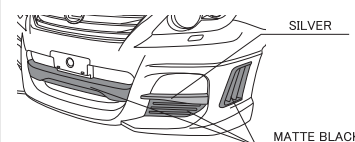

■HOW TO PAINT OEM REINFORCEMENT

Paint OEM reinforcement as necessary.

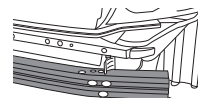

■HOW TO RELOCATE OEM HEADLIGHT WASHERS (STEP 6)
Relocate OEM headlight washer covers and nozzles to WALD Front Bumper.

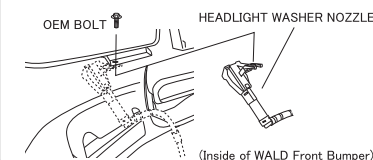

■HOW TO INSTALL PTS (STEP 6)
Remove PTS and bases, then use caulking glue to fix them to WALD Front Bumper from the rear.

■HOW TO INSTALL THE ATTACHED MESHERS (STEP 6)

Use pins and caulking glue to install the attached meshes to WALD Front Bumper from the rear.

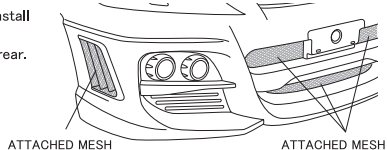

ATTENTION

- ※MORE THAN 2 TECHNICIANS ARE NECESSARY IN THIS WORK. DURING ALL THE INSTALLATION PROCESS, PLEASE BE CAREFUL NOT TO DAMAGE THE BODY.
- ※DEGREASE ALL THE INSTALLATION POSITIONS, AND REMOVE THE BODY PROTECTION COATING BEFORE THE INSTALLATION.

OEM CLIP

OEM TAPPING SCREW

ATTACHED LED LAMP KIT

OEM HEADLIGHT WASHER COVER

※Use OEM resin parts to install WALD Front Bumper.
(Exactly same with OEM installation process)
(Inside of WALD Front Bumper)



LEXUS LX570

WALD SPORTS LINE
BLACK BISON EDITION

INSTALLATION MANUAL
WALD
Sportliche Autoausrüstung WALD.International

THANK YOU FOR PURCHASING. THIS IS THE INSTALLATION MANUAL OF WALD REAR BUMPER FOR LEXUS LX570.

ATTENTION



- ※ NO RETURNS CAN BE ACCEPTED BECAUSE OF IMPROPER INSTALLATION OR PAINTING.
- ※ CHECK THE FITMENT, AND ADJUST ALL THE DETAILS BEFORE PAINTING.
- We assume no responsibility for any damage resulting from improper installation, painting, modification and any cut wound in unsealing.
- Contact the car dealer when you have any question in removing OEM parts.
- During all the installation process, use parking brake and stop the engine completely.
- Use rasps or sandpapers to fit the products to the body if there is an individual difference.
- The product is made of FRP. Handle with care. Do not give the excessive force.
- Gradually fix the bolts and nuts by checking the fitment and balance of the installation.
- After making a hole on the body, make the corrosion treatment on it.
- Check the fitment, and adjust all the details of the fitment steady and proper.
- Please check the fitment and all the details regularly, fix the bolts and nuts as necessary.
- The instruction of painting is just our recommendation, please paint it as you like.
- ※ PLEASE BE AWARE OF:
 - You may lose the warranty and all the services from the car maker, because of replacing OEM parts.
 - Reduced road clearance may cause inconvenience in using parking curbs and garage jack.
 - FRP, ABS and PPE products are slightly weaker than OEM parts in crashes.
 - The product may not match the body and OEM color perfectly.

Please purchase double sided tape, primer and caulking glue at auto accessory shop or hardware store.

Completely degrease and paint primer on all the installation positions to enhance the viscosity of double sided tape.

Use dryer to warm double sided tape to enhance the viscosity in low temperature.

Keep the car in a dry condition more than 24 hours after gluing.

Do not wash the car during this time.

	PARTS	QUANTITIES
REAR BUMPER	REAR BUMPER	1
	REFLECTORS	2
	MESHERS	1 SET
	REAR UNDER BRACKETS	2
	REAR SIDE BRACKETS	2
	BOLTS (M6 x 16) & NUTS	4 SET
	HITCH COVER (TRAILER HITCH EQUIPPED ONLY)	1
	BOLTS (M6 x 16)	4

Use caulking glue to fill the gap between the product and the body.

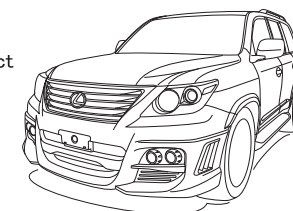

REAR BUMPER

[BEFORE PAINTING]

- 1) Remove OEM rear bumper according to the Lexus service manual.
- 2) Remove OEM resin parts according to the picture.
- 3) Temporarily install WALD Rear Bumper to the body.
- ※ Install the attached hitch cover to the car equipped trailer hitch.
- ※ Adjust the details of WALD Rear Bumper to fit the body by rasps or sandpapers.
- 4) Paint WALD Rear Bumper according to the picture.

[AFTER PAINTING]

- 5) Use caulking glue to install the attached meshes to WALD Rear Bumper from the rear.
- 6) Remove PTS and bases, then use caulking glue to fix them to WALD Rear Bumper from the rear.
- 7) Temporarily fix all the rear under brackets, rear side brackets, clips, bolts and nuts to install WALD Rear Bumper to the body.
- 8) Check all the details of the fitment, then fix them.

※WALD SHOWCAR IS PAINTED LIKE THE PICTURE (STEP 4)

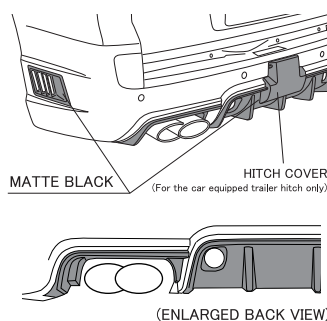

■HOW TO INSTALL THE ATTACHED HITCH COVER (STEP 3,8)

Install the attached hitch cover to the car equipped trailer hitch.

※Adjust the details of the attached hitch cover to fit WALD Rear Bumper by rasps or sandpapers.



Please confirm the fitting of the Towing Hook and WALD Rear Bumper before painting.

■HOW TO INSTALL THE ATTACHED MESHERS (STEP 5)

Use pins and caulking glue to install the attached meshes to WALD Rear Bumper from the rear.



ATTENTION

※MORE THAN 2 TECHNICIANS ARE NECESSARY IN THIS WORK. DURING ALL THE INSTALLATION PROCESS, PLEASE BE CAREFUL NOT TO DAMAGE THE BODY.

※DEGREASE ALL THE INSTALLATION POSITIONS, AND REMOVE THE BODY PROTECTION COATING BEFORE THE INSTALLATION.

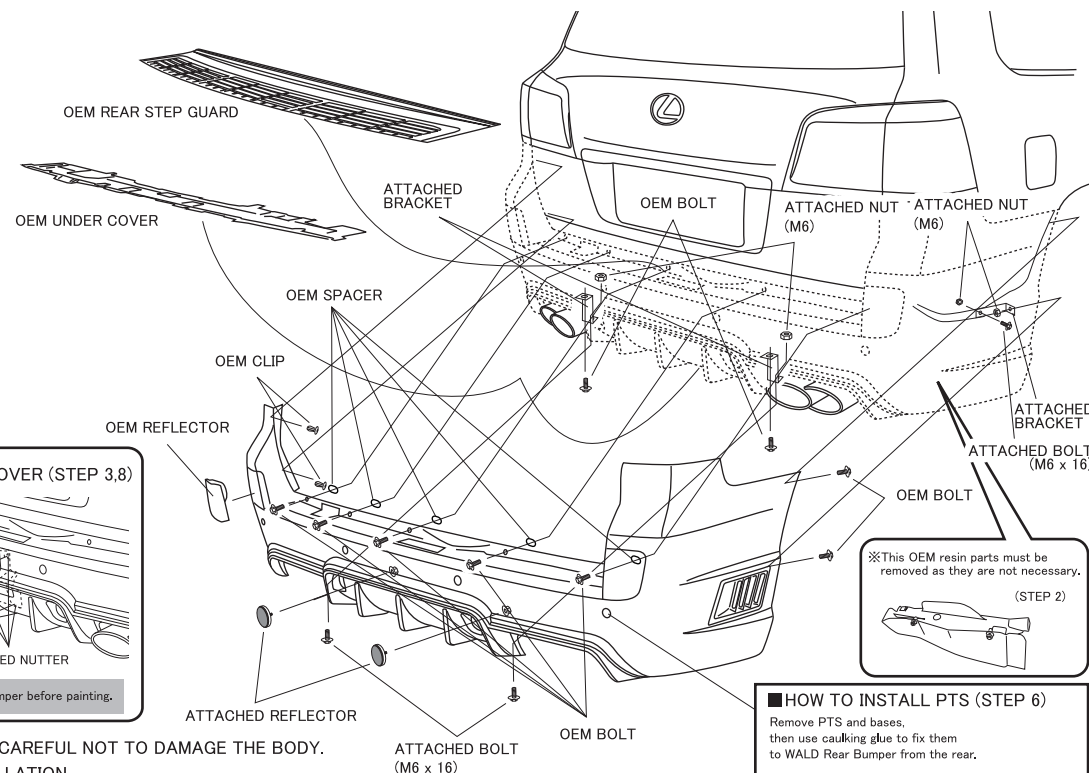

※This OEM resin parts must be removed as they are not necessary. (STEP 2)

■HOW TO INSTALL PTS (STEP 6)

Remove PTS and bases, then use caulking glue to fix them to WALD Rear Bumper from the rear.

LEXUS LX570

WALD SPORTS LINE
BLACK BISON EDITION

INSTALLATION MANUAL
WALD
Sportliche Autoausrüstung WALD.International

THANK YOU FOR PURCHASING. THIS IS THE INSTALLATION MANUAL OF WALD OVER FENDERS FOR LEXUS LX570.

ATTENTION



- ※ NO RETURNS CAN BE ACCEPTED BECAUSE OF IMPROPER INSTALLATION OR PAINTING.
- ※ CHECK THE FITMENT, AND ADJUST ALL THE DETAILS BEFORE PAINTING.
- We assume no responsibility for any damage resulting from improper installation, painting, modification and any cut wound in unsealing.
- Contact the car dealer when you have any question in removing OEM parts.
- During all the installation process, use parking brake and stop the engine completely.
- Use rasps or sandpapers to fit the products to the body if there is an individual difference.
- The product is made of FRP. Handle with care. Do not give the excessive force.
- Gradually fix the bolts and nuts by checking the fitment and balance of the installation.
- After making a hole on the body, make the corrosion treatment on it.
- Check the fitment, and adjust all the details of the fitment steady and proper.
- Please check the fitment and all the details regularly, fix the bolts and nuts as necessary.
- The instruction of painting is just our recommendation, please paint it as you like.
- ※ PLEASE BE AWARE OF:
 - You may lose the warranty and all the services from the car maker, because of replacing OEM parts.
 - Reduced road clearance may cause inconvenience in using parking curbs and garage jack.
 - FRP, ABS and PPE products are slightly weaker than OEM parts in crashes.
 - The product may not match the body and OEM color perfectly.

Please purchase double sided tape, primer and caulking glue at auto accessory shop or hardware store.

Completely degrease and paint primer on all the installation positions to enhance the viscosity of double sided tape.
Use dryer to warm double sided tape to enhance the viscosity in low temperature.
Keep the car in a dry condition more than 24 hours after gluing.
Do not wash the car during this time.

	PARTS	QUANTITIES
	OVER FENDERS	1 SET
OVER FENDER	TAPPING SCREWS (M5 x 16)	14



Use caulking glue to fill the gap between the product and the body.

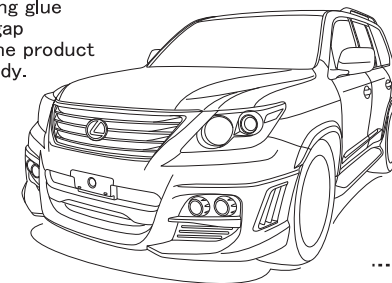

OVER FENDER

【BEFORE PAINTING】

- 1) Temporarily install WALD Over Fenders to the body.
- ※ Adjust the details of WALD Over Fenders to fit the body by rasps or sandpapers.
- 2) Check the fitment, then use masking tape to mark the installation positions.

【AFTER PAINTING】

- 3) Completely degrease the installation positions of WALD Over Fenders.
- 4) Use caulking glue to install WALD Over Fenders to the body.
- 5) Temporarily fix the attached tapping screws to install WALD Over Fenders to the body.
- 6) Check all the details of the fitment, then use masking tape to fix them, leave till completely fixed.

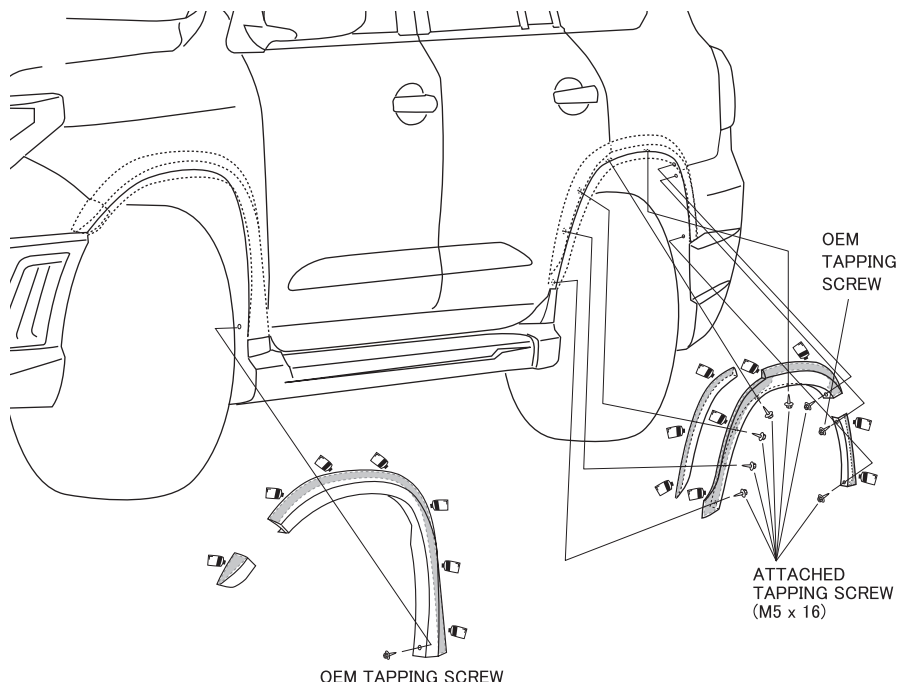

ATTENTION

- ※ DURING ALL THE INSTALLATION PROCESS, PLEASE BE CAREFUL NOT TO DAMAGE THE BODY.
- ※ DEGREASE ALL THE INSTALLATION POSITIONS, AND REMOVE THE BODY PROTECTION COATING BEFORE THE INSTALLATION.



WALD INTERNATIONAL

WALD INTERNATIONAL

ADD: 10-13 KYOGUCHI-CHO, TAKATSUKI, OSAKA, JAPAN ZIP: 569-0072 TEL: (81)-72-673-3000 FAX: (81)-72-673-3003

WALD INTERNATIONAL

LEXUS LX570

WALD SPORTS LINE
BLACK BISON EDITION

INSTALLATION MANUAL
WALD
Sportliche Autoausrüstung WALD.International

THANK YOU FOR PURCHASING. THIS IS THE INSTALLATION MANUAL OF FOG LAMP KIT OF WALD FRONT BUMPER FOR LEXUS LX570.

ATTENTION



- ※ NO RETURNS CAN BE ACCEPTED BECAUSE OF IMPROPER INSTALLATION OR PAINTING.
- ※ CHECK THE FITMENT, AND ADJUST ALL THE DETAILS BEFORE PAINTING.
- We assume no responsibility for any damage resulting from improper installation, painting, modification and any cut wound in unsealing.
- Contact the car dealer when you have any question in removing OEM parts.
- During all the installation process, use parking brake and stop the engine completely.
- Use rasps or sandpapers to fit the products to the body if there is an individual difference.
- The product is made of FRP. Handle with care. Do not give the excessive force.
- Gradually fix the bolts and nuts by checking the fitment and balance of the installation.
- After making a hole on the body, make the corrosion treatment on it.
- Check the fitment, and adjust all the details of the fitment steady and proper.
- Please check the fitment and all the details regularly, fix the bolts and nuts as necessary.
- The instruction of painting is just our recommendation, please paint it as you like.
- ※ PLEASE BE AWARE OF:
 - You may lose the warranty and all the services from the car maker, because of replacing OEM parts.
 - Reduced road clearance may cause inconvenience in using parking curbs and garage jack.
 - FRP, ABS and PPE products are slightly weaker than OEM parts in crashes.
 - The product may not match the body and OEM color perfectly.

Please purchase double sided tape, primer and caulking glue at auto accessory shop or hardware store.

Completely degrease and paint primer on all the installation positions to enhance the viscosity of double sided tape.
Use dryer to warm double sided tape to enhance the viscosity in low temperature.
Keep the car in a dry condition more than 24 hours after gluing.
Do not wash the car during this time.

	PARTS	QUANTITIES
FOG LAMP KIT	FOG LAMPS	2 SETS
	FOG LAMP COVERS	1 SET
	TAPPING SCREWS (M6 x 16)	8
	BOLTS (M5 x 16) & NUTS	8 SETS



Use caulking glue to fill the gap between the product and the body.

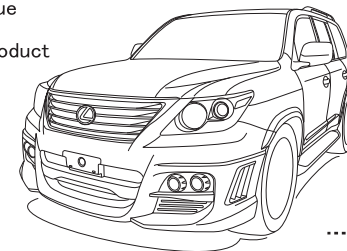

FOG LAMP KIT

[BEFORE PAINTING]

- 1) Temporarily install the fog lamp kit to WALD Front Bumper.
- ※ Adjust the details of the fog lamp kit to fit WALD Front Bumper by rasps or sandpapers.
- 2) Prepare to connect the fog lamps.
- ※ Insulate any spare harness.
- 3) Paint the fog lamp covers according to the picture.

[AFTER PAINTING]

- 4) Temporarily fix the attached tapping screws, bolts and nuts to install the fog lamp kit to WALD Front Bumper.
- 5) Check all the details of the fitment and optical axis, then fix them.
- 6) Use relay harness with remote controller kit to turn on the LED rings and fog lamps separately.

※WALD SHOWCAR IS PAINTED LIKE THE PICTURE (STEP 3)

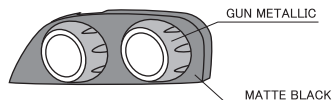

ATTENTION

- ※REMOVE THE BATTERY BEFORE ALL THE WIRING WORKS.
- ※MAKE SURE THE FOG LAMP KIT IS FINE TO WORK BEFORE THE INSTALLATION.

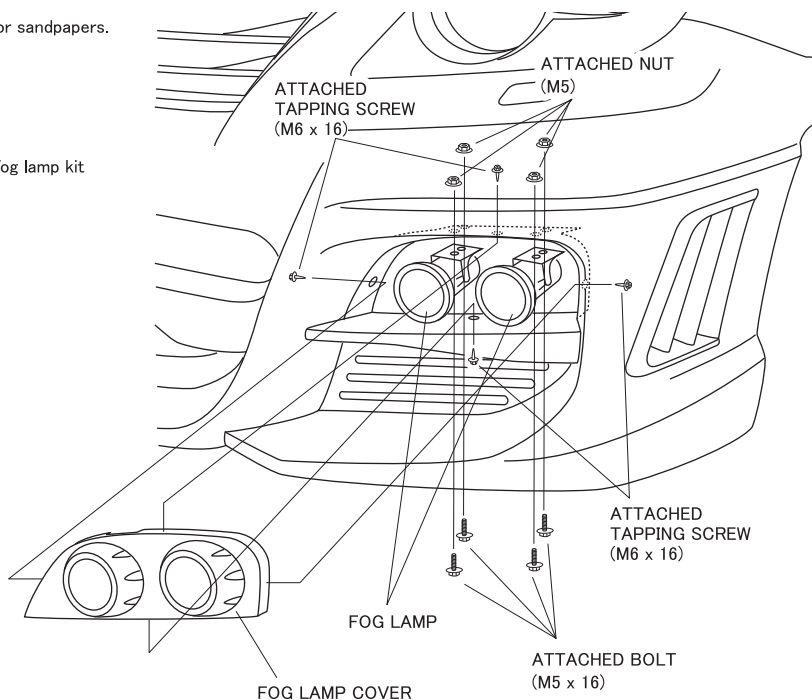

WALD INTERNATIONAL

LEXUS LX570

WALD SPORTS LINE
BLACK BISON EDITION

INSTALLATION MANUAL
WALD
Sportliche Autoausrüstung WALD.International

THANK YOU FOR PURCHASING. THIS IS THE INSTALLATION MANUAL OF LED LAMP KIT OF WALD FRONT BUMPER FOR LEXUS LX570.

ATTENTION



- ※ NO RETURNS CAN BE ACCEPTED BECAUSE OF IMPROPER INSTALLATION OR PAINTING.
- ※ CHECK THE FITMENT, AND ADJUST ALL THE DETAILS BEFORE PAINTING.
- We assume no responsibility for any damage resulting from improper installation, painting, modification and any cut wound in unsealing.
- Contact the car dealer when you have any question in removing OEM parts.
- During all the installation process, use parking brake and stop the engine completely.
- Use rasps or sandpapers to fit the products to the body if there is an individual difference.
- The product is made of FRP. Handle with care. Do not give the excessive force.
- Gradually fix the bolts and nuts by checking the fitment and balance of the installation.
- After making a hole on the body, make the corrosion treatment on it.
- Check the fitment, and adjust all the details of the fitment steady and proper.
- Please check the fitment and all the details regularly, fix the bolts and nuts as necessary.
- The instruction of painting is just our recommendation, please paint it as you like.
- ※ PLEASE BE AWARE OF:
 - You may lose the warranty and all the services from the car maker, because of replacing OEM parts.
 - Reduced road clearance may cause inconvenience in using parking curbs and garage jack.
 - FRP, ABS and PPE products are slightly weaker than OEM parts in crashes.
 - The product may not match the body and OEM color perfectly.

Please purchase double sided tape, primer and caulking glue at auto accessory shop or hardware store.

Completely degrease and paint primer on all the installation positions to enhance the viscosity of double sided tape.
Use dryer to warm double sided tape to enhance the viscosity in low temperature.
Keep the car in a dry condition more than 24 hours after gluing.
Do not wash the car during this time.

	PARTS	QUANTITIES
LED LAMP KIT	LED LAMPS	1 SET
	INSERT ADAPTERS	1 SET
	MESHES	1 SET
	TAPPING SCREWS (M6 x 16)	8
	BOLTS (M6 x 12)	4



Use caulking glue to fill the gap between the product and the body.

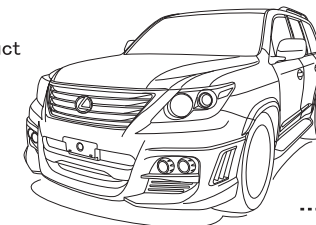

LED LAMP KIT

[BEFORE PAINTING]

- 1) Temporarily install the LED lamp kit to WALD Front Bumper from the rear.
- ※ Adjust the details of the LED lamp kit to fit WALD Front Bumper by rasps or sandpapers.
- 2) Prepare to connect the LED lamps.
- ※ Insulate any spare harness.
- 3) Paint the LED lamp brackets according to the picture.

[AFTER PAINTING]

- 4) Use pins and caulking glue to install the attached meshes to the insert adapters from the rear.
- 5) Temporarily fix the attached tapping screws and bolts to install the LED lamp kit to WALD Front Bumper from the rear.
- 6) Check all the details of the fitment and optical axis, then fix them.

■ HOW TO INSTALL THE ATTACHED MESHES (STEP 4)

Use pins and caulking glue to install the attached meshes to the insert adapters from the rear.

(Inside of the insert adapter)

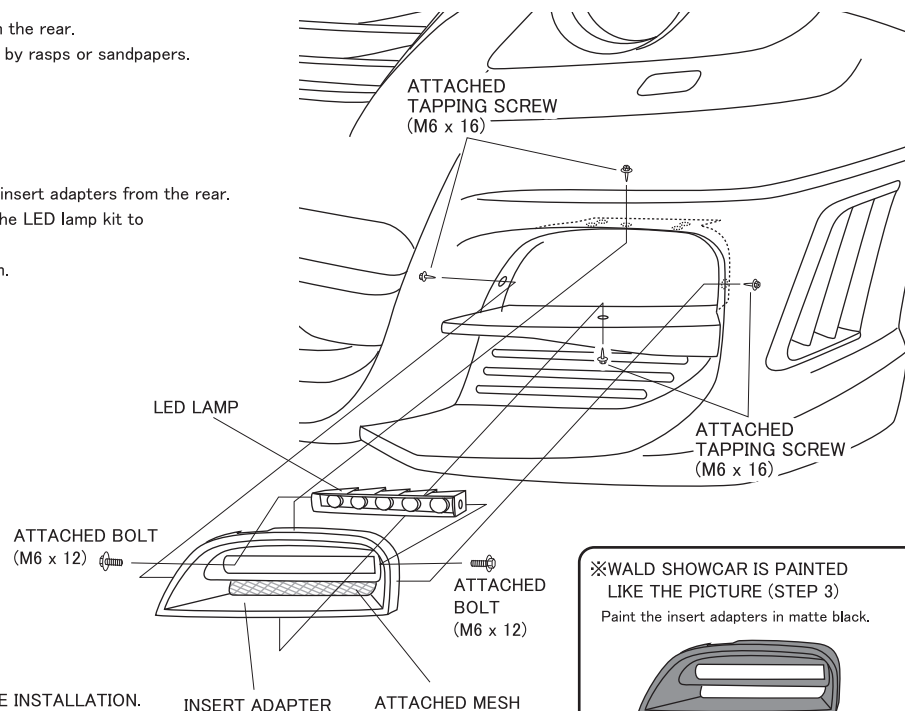
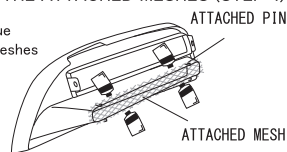

※WALD SHOWCAR IS PAINTED LIKE THE PICTURE (STEP 3)
Paint the insert adapters in matte black.

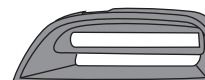

ATTENTION

- ※DEGREASE ALL THE INSTALLATION POSITIONS.
- AND REMOVE THE BODY PROTECTION COATING BEFORE THE INSTALLATION.
- ※REMOVE THE BATTERY BEFORE ALL THE WIRING WORKS.
- ※MAKE SURE THE LED LAMPS ARE FINE TO WORK BEFORE THE INSTALLATION.

= WIRING DIAGRAM =

« AS FOG LAMP »

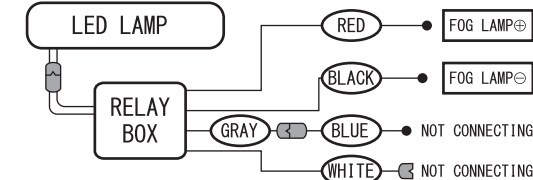

« AS DAYLIGHT »

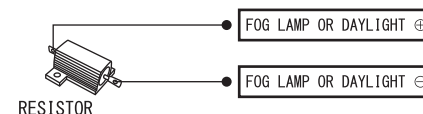
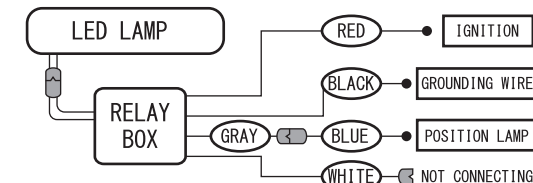

※Install the resistors away from the harness to prevent the heat of them.

CAR SIDE